

# DLX SERIES

## INDUSTRIAL TOUCH SCREEN DISPLAY SERIES

The DLX Series includes the rugged 8.4" (DLX0805) and 12.1" (DLX1205) Touch Screen Displays, designed for the harshest industrial environments imaginable. Featuring a hard anodized, fully sealed (IP67 rated) milled aluminum enclosure, the DLX Series delivers outstanding video quality while enduring constant exposure to shock, vibration, dust, water, and a wide range of temperatures extremes. With standard VGA input, resistive Touch Screen, and an integrated alert speaker, the DLX Series is the preferred tool to monitor the health and outputs of industrial processes.



### STANDARD FEATURES

- VGA Input (1)
- Resistive Strengthened Touch Screen (USB Interface)
- SVGA (8.4") and XGA (12.1") Resolution; 8-bit Color
- Auto Scaling VGA to UXGA
- High Bright LED Backlight (1000:1 Dimming Ratio)
- Anti-Reflective and Anti-Glare Treatments
- Enhanced Sunlight Readability
- Integrated Speaker
- Auto On
- Hard-Anodized Aluminum Enclosure
- Sealed Connectors\*
- IP67/NEMA 6 Enclosure Sealed against Dust and Water
- Shock and Vibration Resistant
- 8.4" and 12.1" TFT AMLCD



\* Cables not included.

### MOUNT OPTIONS

(Quoted individually)



RAM

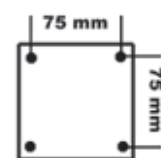

VESA



LCD SIZE	RESOLUTION	LUMINANCE	VIEWING ANGLE	CONTRAST RATIO	MAXIMUM POWER CONSUMPTION
8.4" TFT AMLCD	SVGA (800x600)	700 nits	160° (H) x 160° (V)	900:1	15 Watts
12.1" TFT AMLCD	XGA (1024x768)	1000 nits	140° (H) x 110° (V)	1000:1	20 Watts

### TECHNICAL SPECIFICATIONS

Display	TFT AMLCD (Thin-Film Transistor Active-Matrix Liquid-Crystal Display)
Display Resolution	SVGA or XGA (see above); 8-bit color, 16,777,216 colors
Dimming Ratio	1000:1
Response Time	18ms (8.4"); 30ms (12.1")
Video Input	VGA (1)
Connector/Cable*	<ul style="list-style-type: none"> <li>▪ Amphenol: PT02E14195</li> <li>▪ Mate for Amphenol: PT06E14-19PSR</li> </ul>
Housing	Milled Aluminum, Black Hard Anodized
Mount Options	RAM or VESA (75mm); Quoted individually
Wide Range DC Power Input†	10-36 VDC (12, 24, 28 VDC nominal)
Power Conditioning	Protected against Drop Out, Load Dump, Reverse Polarity and Transients

### ENVIRONMENTAL SPECIFICATIONS

IP Rating	IP67 (NEMA 6 Submersible)
Operating Temperature	-20°C to 60°C (-4°F to 140°F)
Storage Temperature	-51°C to 71°C (-60°F to 160°F)
Humidity	0-100%
Shock	50 G
Vibration	5.8 G (5-500 Hz)
Altitude	45,000 ft.
EMI	FCC Class A, CE, UL, TUV

\* - Cables not included.

† - Power range specified covers momentary environmental fluctuations generally found in a mobile environment while display is operating. For power initialization and continual operation, nominal voltages are required.

ON-GOING PRODUCT DEVELOPMENT MAY NECESSITATE DESIGN AND SPECIFICATION CHANGES WITHOUT NOTICE.

DLX SERIES(D)® 1/2022



**DIGITAL SYSTEMS ENGINEERING, INC. (DSE)**

17491 NORTH 93RD STREET

SCOTTSDALE, AZ 85255-6324 | 480-515-1110 | WWW.DIGITALSYS.COM

